

LOCATION MAP

SCALE: 1" = 2000'
Copyright ADG The Map People
Permitted Use No. 20506149

NOTES:

1. TAX MAP IN PARCELS 15, 21, 24, 280 AND 186 SHOWN HEREON WERE SURVEYED BY MORRIS & RITCHE ASSOCIATES, INC. WITHOUT BENEFIT OF A TITLE REPORT.
2. TAX MAP IN PARCELS 15, 21, 11, 165, 210 AND 231, TAX MAP IN PARCELS 6 AND 231 WERE SURVEYED BY RODGERS CONSULTING, INC. WITH THE BENEFIT OF A TITLE REPORT.
3. EXISTING CORPORATE LIMITS BOUNDARY INFORMATION HAS TAKEN FROM A DESCRIPTION SUPPLIED BY THE TOWN OF THURMONT, ENTITLED "DESCRIPTION OF THE CORPORATE BOUNDS OF THE TOWN OF THURMONT (AS OF JANUARY 1, 2001)".
4. TOPOGRAPHY SHOWN HEREON IS A COMBINATION OF FIELD RUN TOPOGRAPHY AND AERIAL TOPOGRAPHY SUPPLIED BY POTOMAC AERIAL SURVEYS.

TOTAL ANNEXATION AREA
9,127,664.45 Sq. Ft. OR 209.542 Ac.±

**A1
AGRICULTURAL
+/-113 ACRES**

**B3
GENERAL BUSINESS
+/- 81 ACRES**

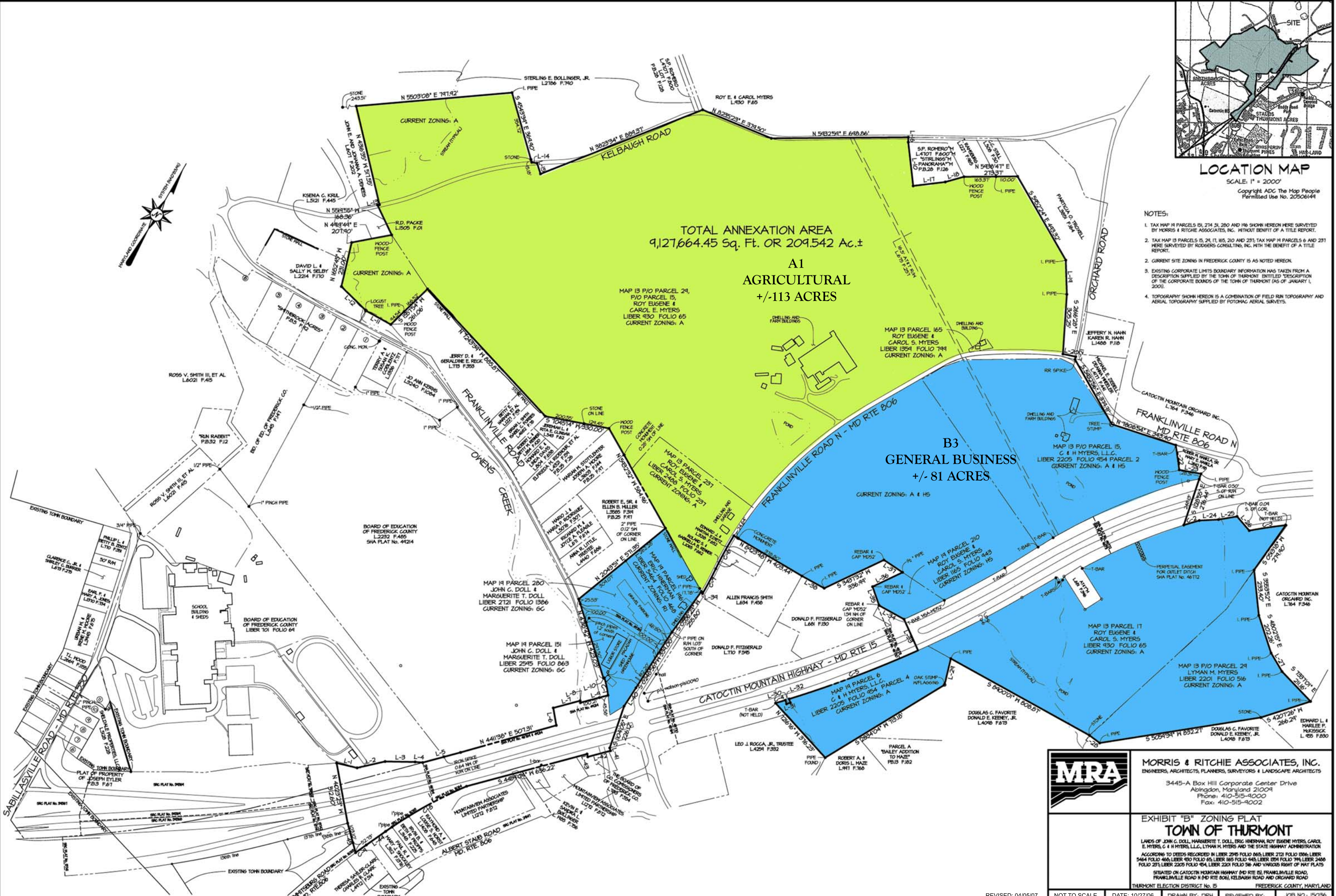

MORRIS & RITCHE ASSOCIATES, INC.
ENGINEERS, ARCHITECTS, PLANNERS, SURVEYORS & LANDSCAPE ARCHITECTS
3445-A Box Hill Corporate Center Drive
Abingdon, Maryland 21009
Phone: 410-515-4000
Fax: 410-515-4002

**EXHIBIT "B" ZONING PLAT
TOWN OF THURMONT**
LANDS OF JOHN C. DOLL, MARGUERITE T. DOLL, ERIC HINERMAN, ROY EUGENE MYERS, CAROL E. MYERS, C & H MYERS, L.L.C., LYMAN M. MYERS AND THE STATE HIGHWAY ADMINISTRATION
ACCORDING TO DEEDS RECORDED IN LIBER 2205 FOLIO 065, LIBER 2121 FOLIO 086, LIBER 2464 FOLIO 465, LIBER 430 FOLIO 045, LIBER 185 FOLIO 445, LIBER 100 FOLIO 794, LIBER 2466 FOLIO 281, LIBER 2205 FOLIO 054, LIBER 2201 FOLIO 036, AND VARIOUS RIGHTS OF WAY PLATS.
SITUATED ON CATOCTIN MOUNTAIN HIGHWAY (MD RTE 15), FRANKLINVILLE ROAD, FRANKLINVILLE ROAD N (MD RTE 806), KELBAUGH ROAD AND ORCHARD ROAD
THURMONT ELECTION DISTRICT No. 15
FREDERICK COUNTY, MARYLAND